

SURGERY CLINICAL SITES – Studying, lounging, storage, etc.

BAPTIST

Graduate Medical Education office

6025 Walnut Grove, Suite 417

This area can be used for lunch (microwave/fridge), studying, computer use, phone use, taking a break (tv, couch, etc).

From the main hospital, walk across the crosswalk into the 6025 building, take the elevators to the 4th floor, Room 417.

From the parking garage, walk across the green bridge and walk across the breezeway. Take the elevators to the left to the 4th floor, Room 417.



Bronstein Library

6025 Walnut Grove, Medical Plaza 1

Walk into the 6025 building, go down the stairs, turn right take another right at dead end wall and the library is on your right at the tunnel

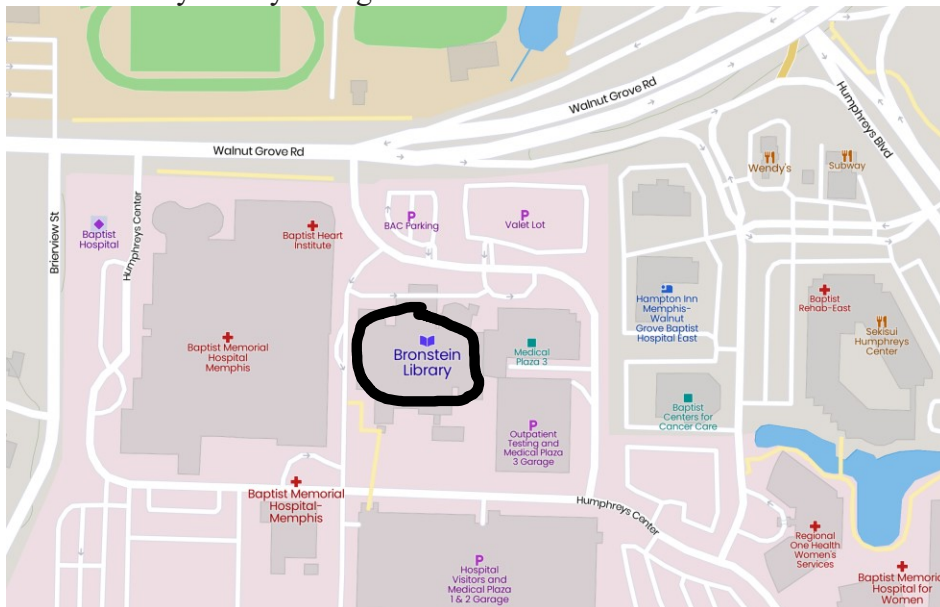

Physicians' Lounge

6019 Walnut Grove

From the main entrance of the hospital, take the elevators to C. The Physicians' Lounge is across from elevators on the concourse level.

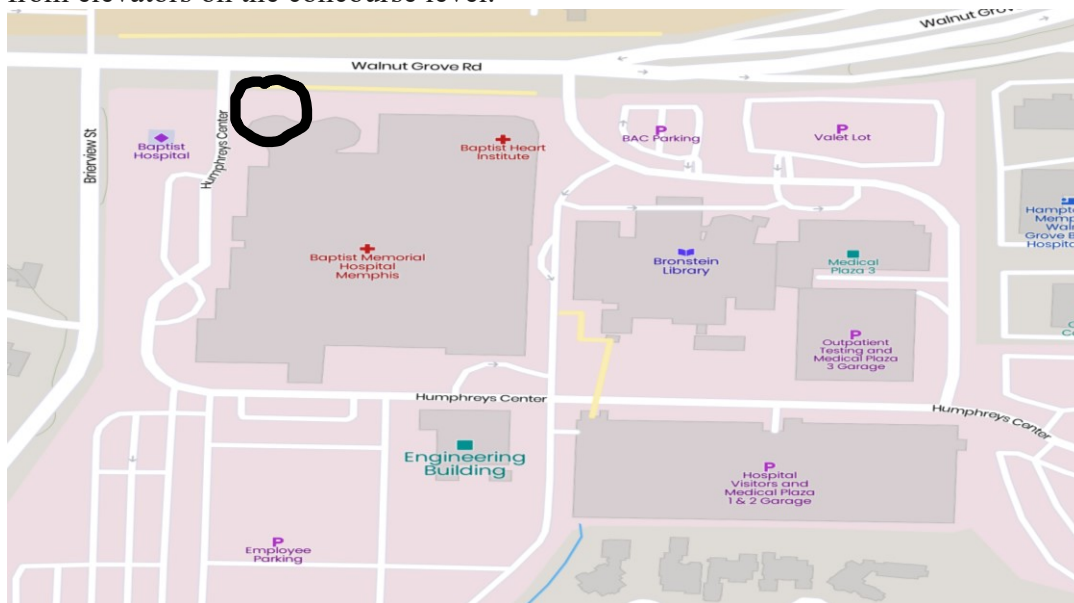

LEBONHEUR

For Pediatric Surgery students, OR Lounge. From the main entrance on Jefferson, take the elevators to the 2nd floor. Go left and walk down to the double doors at the end of the hallway (badge entrance only). The area should be labeled as “Faculty Lounge” on the right. There are storage areas inside the OR.

Lebonheur 2nd floor Surgery Lounge

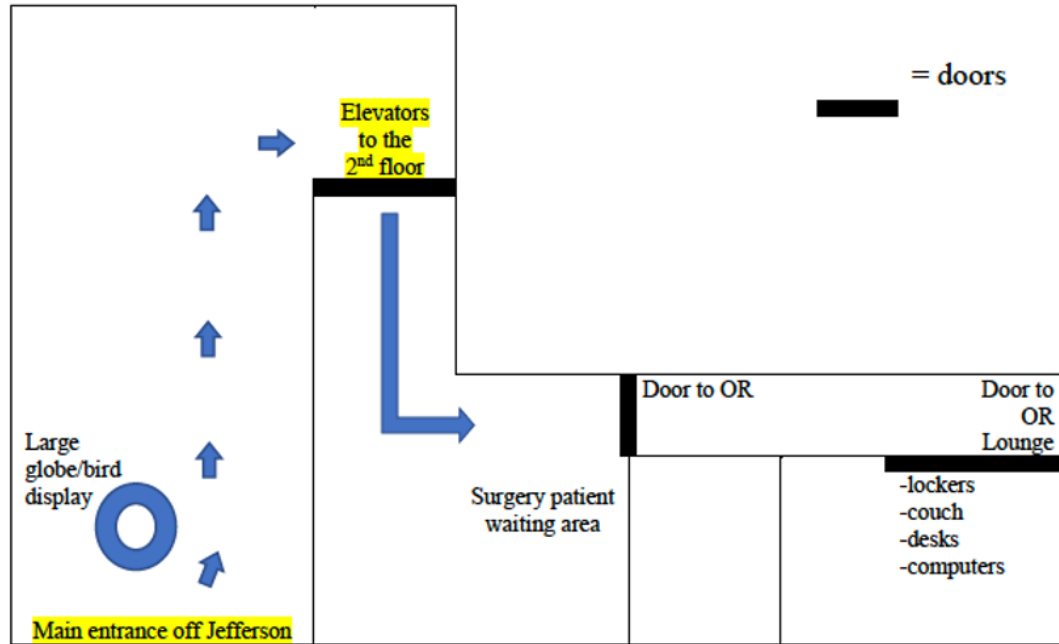

METHODIST UNIVERSITY

Female Lockers: CV Hall staff locker room

Male Lockers: SHORB staff locker room (not the same as the surgeon/resident locker room)

Lockers and codes are issued by Courtney Bishop for Surgery Clerkship students only.

MUH- lockers for storage, and lounges for study, as described in map. All on 3rd floor of Shorb tower

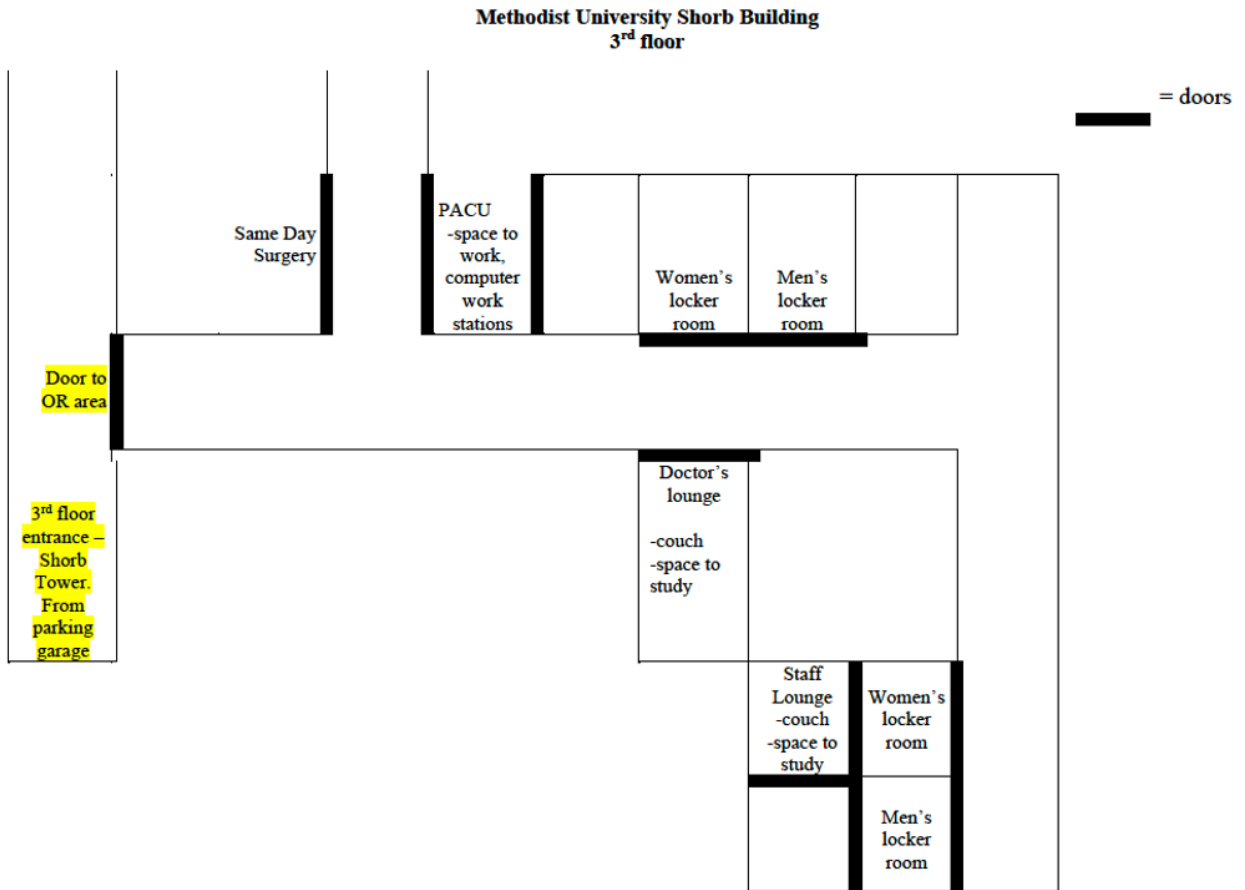

REGIONAL ONE HEALTH

The “Breakroom” is located in CCA, Ground floor, Jefferson Building.

For Trauma, the study spaces, workspaces and storage are all in the Trauma Training Center (TTC). Located on the ground floor. The “main elevators” in the map below are located right by the CCA, by the Jefferson Emergency Department entrance.

For General Surgery, 4th floor Chandler OR lounge. Students may also store items in the TTC. The “main elevators” in the map below are located right by the CCA, by the Jefferson Emergency Department entrance.

Regional One Health Trauma and General Surgery

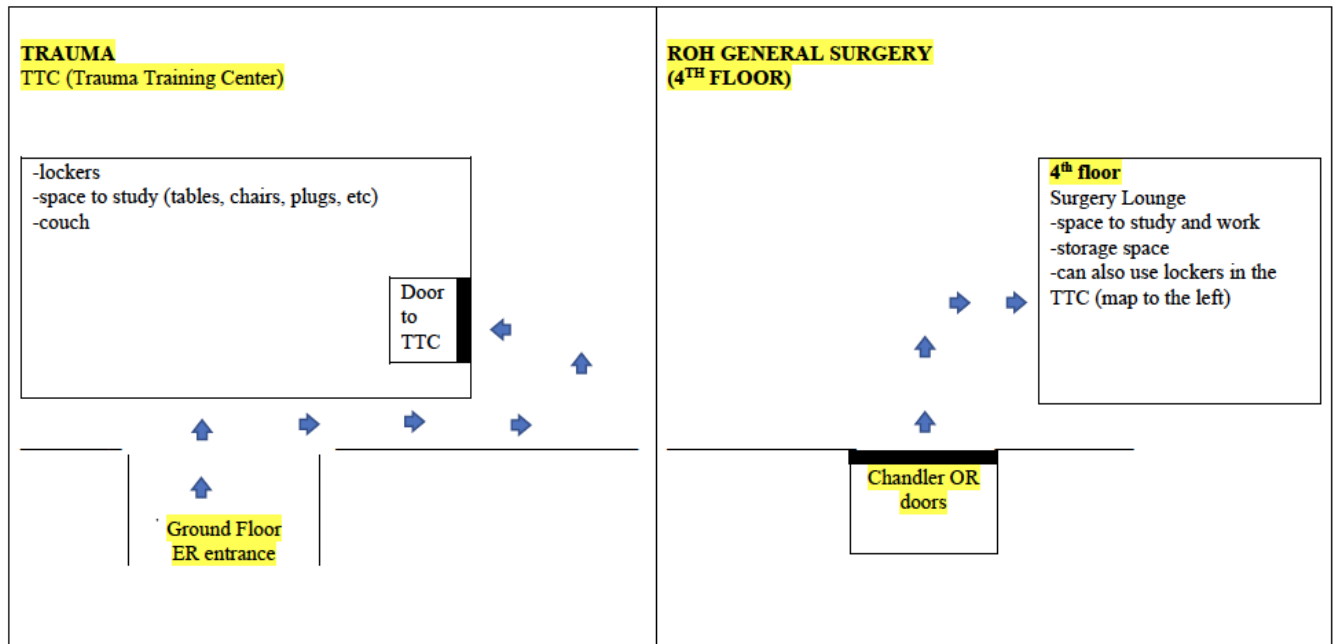

 = doors

ROH Overnight Call Rooms

Location: Adams Building 4th and 6th floors

Contact for reservations: Kayla Ingram at kingram2@regionalonehealth.org or 901-545-7960.

Please contact Ms. Ingram at least one week prior for a reservation.

Directions: From 877 Jefferson, take the elevators to the 2nd floor. Once on the 2nd floor take the breezeway over to the Adams building. Use your ROH ID badge for access through the double doors. Once through the double doors, make a right and take the elevators to the 4th floor of the Adams building. On the 4th floor, sleep rooms (use badge for access) are located through the double doors to the right of the Adams elevators near the stairwell.

VA MEDICAL CENTER

VA Medical Center located at 1030 Jefferson

3rd floor lounge for all the needs. The lounge is locked with a key code that the students on service are given.

VA Medical Center

